

- REFERENCE PLANS:
1. "LAND OF - EST. OF TRACY A. EATON, - MASON & GREENVILLE, - N.H." SCALE: 1"=200' DATED 1972 PREPARED BY J. PRESTON, SURVEYOR (H.C.R.D. PLAN NO. 7433).
 2. "PART OF LAND OF - BRONSON M. POTTER - ET AL - MASON, N.H." SCALE: 1"=400' DATED 1974 PREPARED BY J. PRESTON, SURVEYOR (H.C.R.D. PLAN NO. 7534).
 3. "PLAT OF - BAKER-POTTER SUBDIVISION - MASON, N.H." SCALE: AS SHOWN DATED OCTOBER 21, 1978 PREPARED BY ROBERT B. TODD, R.L.S. (H.C.R.D. PLAN NO. 11707).
 4. "PLAN OF LAND OF M. BARBARA SCHULZE - OLD BROOKLINE & WILTON ROADS, MASON, N.H." SCALE: 1"=100' DATED JULY 8, 1980 PREPARED BY WILLIAM A. BEHN, JR. R.L.S. (H.C.R.D. PLAN NO. 16454).

- NOTES:
1. OWNER OF RECORD IS BRONSON M. POTTER, GREENVILLE ROAD, MASON, N.H. 03048.
 2. DEED REFERENCES TO THE PARCEL ARE VOLUME 2548 PAGE 330 DATED 10/25/77, VOLUME 2311 PAGE 344 DATED 07/03/73 AND VOLUME 2658 PAGE 722 DATED 11/16/70 IN THE HILLSBOROUGH COUNTY REGISTRY OF DEEDS.
 3. TOTAL AREA OF THE PARCEL BEING SUBDIVIDED IS 115.247 ACRES.
 4. PARCEL IS IN THE GENERAL RESIDENTIAL, AGRICULTURAL, AND FORESTRY (GRAF) DISTRICT.
 5. "THE SUBDIVISION REGULATIONS OF THE TOWN OF MASON ARE A PART OF THIS PLAT, AND APPROVAL OF THIS PLAT IS CONTINGENT ON COMPLETION OF ALL THE REQUIREMENTS OF SAID SUBDIVISION REGULATIONS, EXCEPTING ONLY ANY VARIANCES OR MODIFICATIONS MADE IN WRITING BY THE BOARD AND ATTACHED HERETO.
 6. LOT C-5-1 IS NOT APPROVED AS A BUILDING LOT. ANY SEPARATE CONVEYANCE OF LOT C-5-1 SHALL INCORPORATE RESTRICTIVE COVENANTS FOR CONSERVATION, AGRICULTURAL AND SILVICULTURAL PURPOSES.

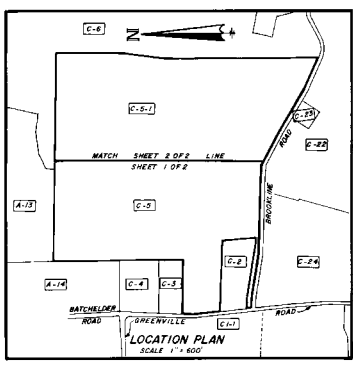

APPROVED SUBJECT TO THE CONDITIONS OF APPROVAL REFERENCED IN THE PLANNING BOARD MINUTES OF 7/27/89

APPROVED BY THE MASON, N.H. PLANNING BOARD ON 7/27/89 CERTIFIED BY Robert W. Schaff CHAIRMAN AND SECRETARY

I HEREBY CERTIFY THAT THIS PLAN IS THE RESULT OF AN ACTUAL SURVEY MADE ON THE GROUND AND HAS A MINIMUM RELATIVE ERROR OF CLOSURE OF ONE PART IN TEN THOUSAND ON ALL PROPERTY LINES. ALL MONUMENTS WERE FOUND OR SET AS SHOWN

10 / 23 / 89
DATE

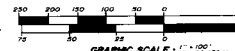

**SUBDIVISION
PLAN OF LAND
BRONSON M. POTTER
MASON, NEW HAMPSHIRE**

SCALE: 1"=100' OCTOBER 23, 1989

DATE	REVISION	BY	CHK
10/23/89	REVISED NOTE 6	SKA	SKA
10/23/89	UPDATE ABUTTERS	SKA	SKA
10/23/89	REVISION	SKA	SKA

MONADNOCK SURVEY, INC. LAND SURVEYORS AND PLANNERS
WILTON STATION-MAIN STREET-P.O. BOX 607-WILTON, N.H. 03086 (603)654-2345